

B. Dean Johnson Architects PC 7710 Maitage Drive Liverpool, New York 13090 315 - 632 - 5622	
THE WEXFORD FOUR BEDROOM	
PROJECT:	MASON CUSTOM HOMES 5146 JAMESVILLE ROAD JAMESVILLE, NY 13078 315-446-1480
DATE:	09-25-18
SCALE:	1/4" = 1'-0"
DRAWN:	LMC/JLP/JDS
CHECKED:	BDJ
DRAWING:	FIRST FLOOR PLAN
DRAWING NO:	2 OF 3

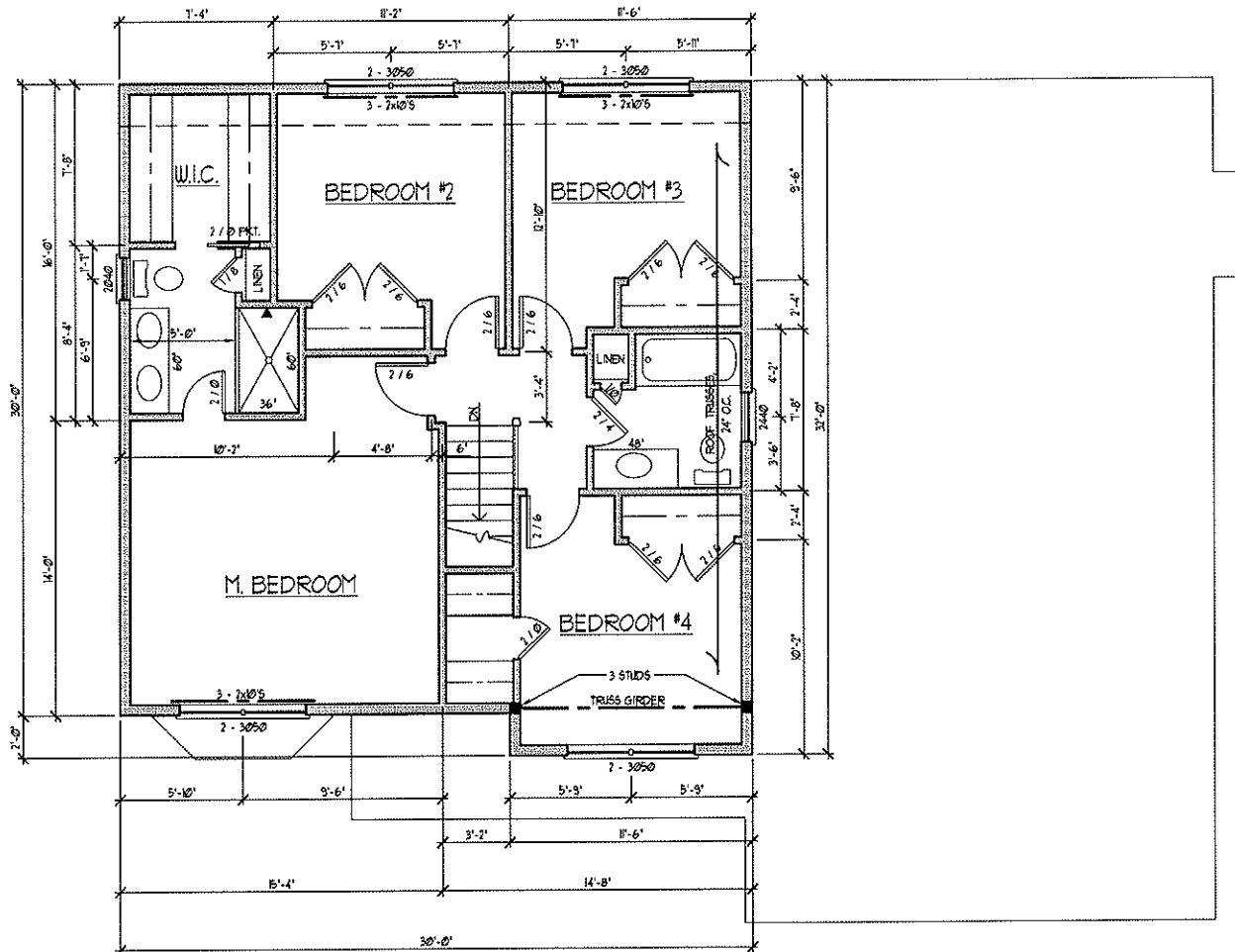

ARCHITECT:	B. Dean Johnson 7706 Maitlage Drive Liverpool, New York 13090 315 - 652 - 5622
PROJECT:	THE WEXFORD FOUR BEDROOM
BUILDER:	MASON CUSTOM HOMES 5145 JAMESVILLE ROAD JAMESVILLE, NY 13078 315-446-1480
DATE:	09-25-18
SCALE:	1/4" = 1'-0"
DRAWN:	LMC / JDS
CHECKED:	BBJ
DRAWING:	SECOND FLOOR PLAN
DRAWING NO:	3 OF 3